

# DOZIER BUILDING

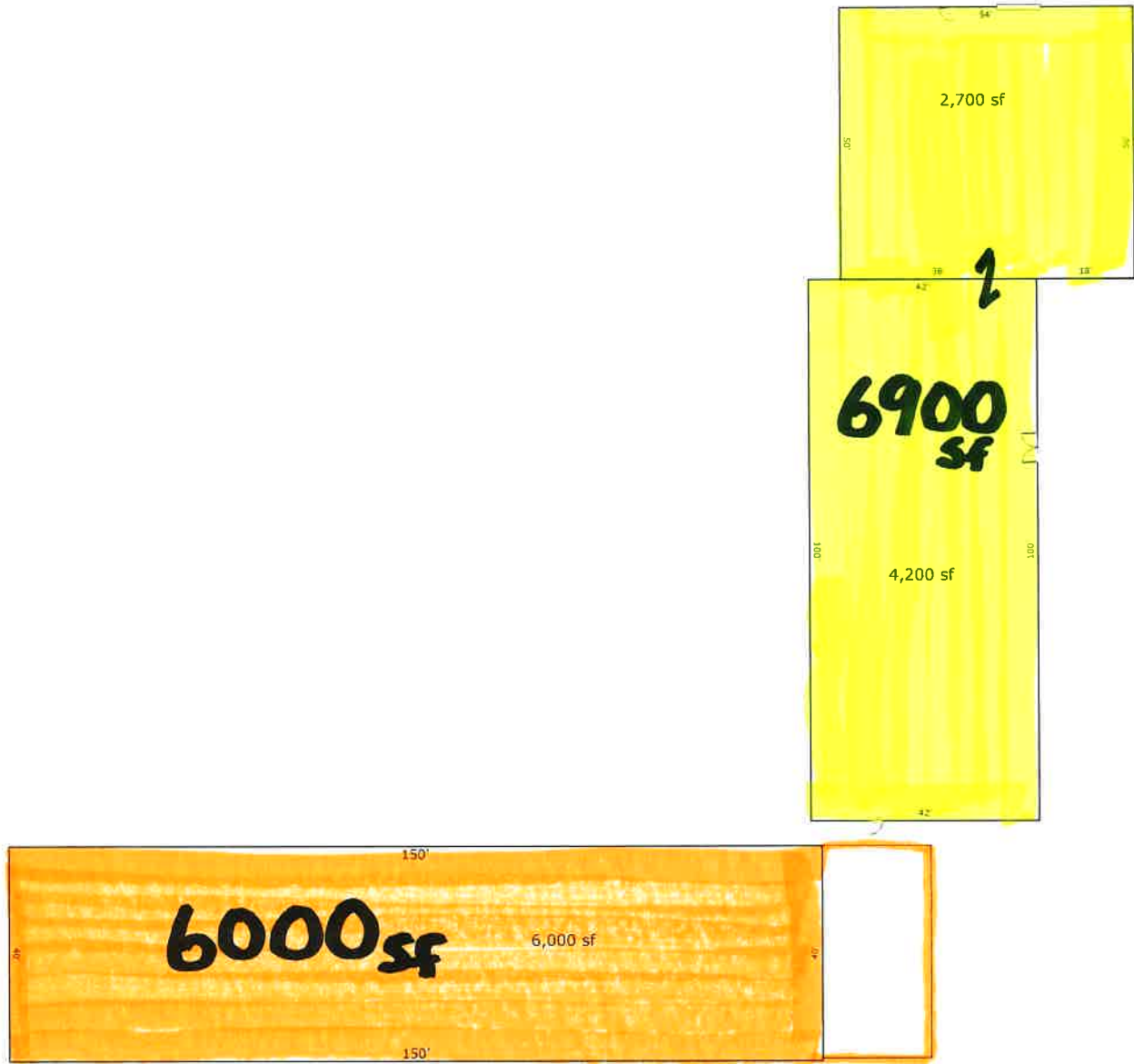

TOTAL Sketch by a la mode, inc.

## Area Calculations Summary

### Living Area

Concrete Patio

2700 Sq ft

First Floor

4200 Sq ft

Second Floor

6000 Sq ft

**Total Living Area (Rounded):**

**12900 Sq ft**

### Calculation Details

$$50 \times 54 = 2700$$

$$100 \times 42 = 4200$$

$$40 \times 150 = 6000$$

6900